

TOWNSHIP ROADS

LEGEND

- Twp or County Line
- Corporate Limits
- State Trunkline
- County Primary
- County Local
- Adjacent County
- Railroad

M-1

Hillsdale Township

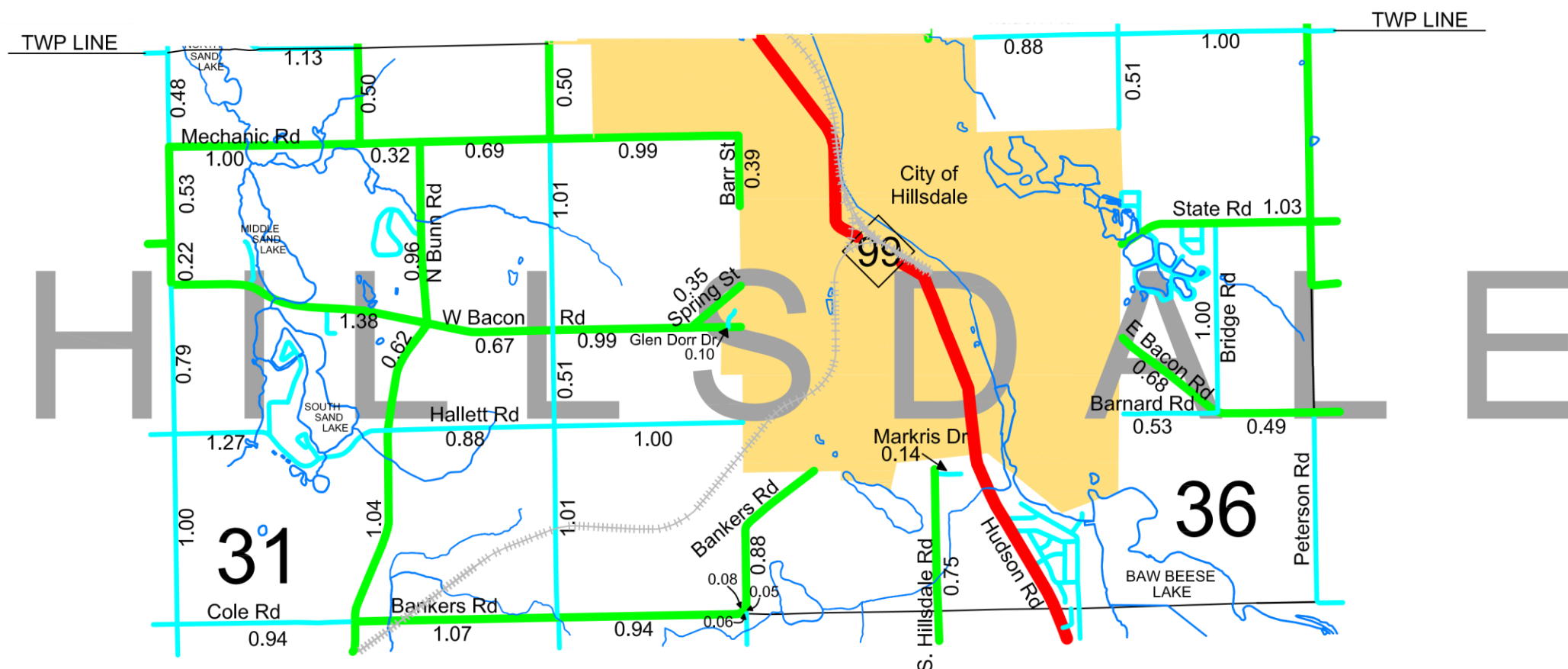

Primary Roads = 17.07 miles
Local Roads = 11.28 miles

Scale: 1.25" = 1.0 mile

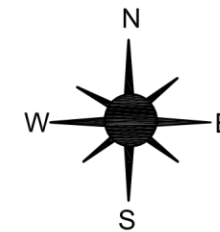

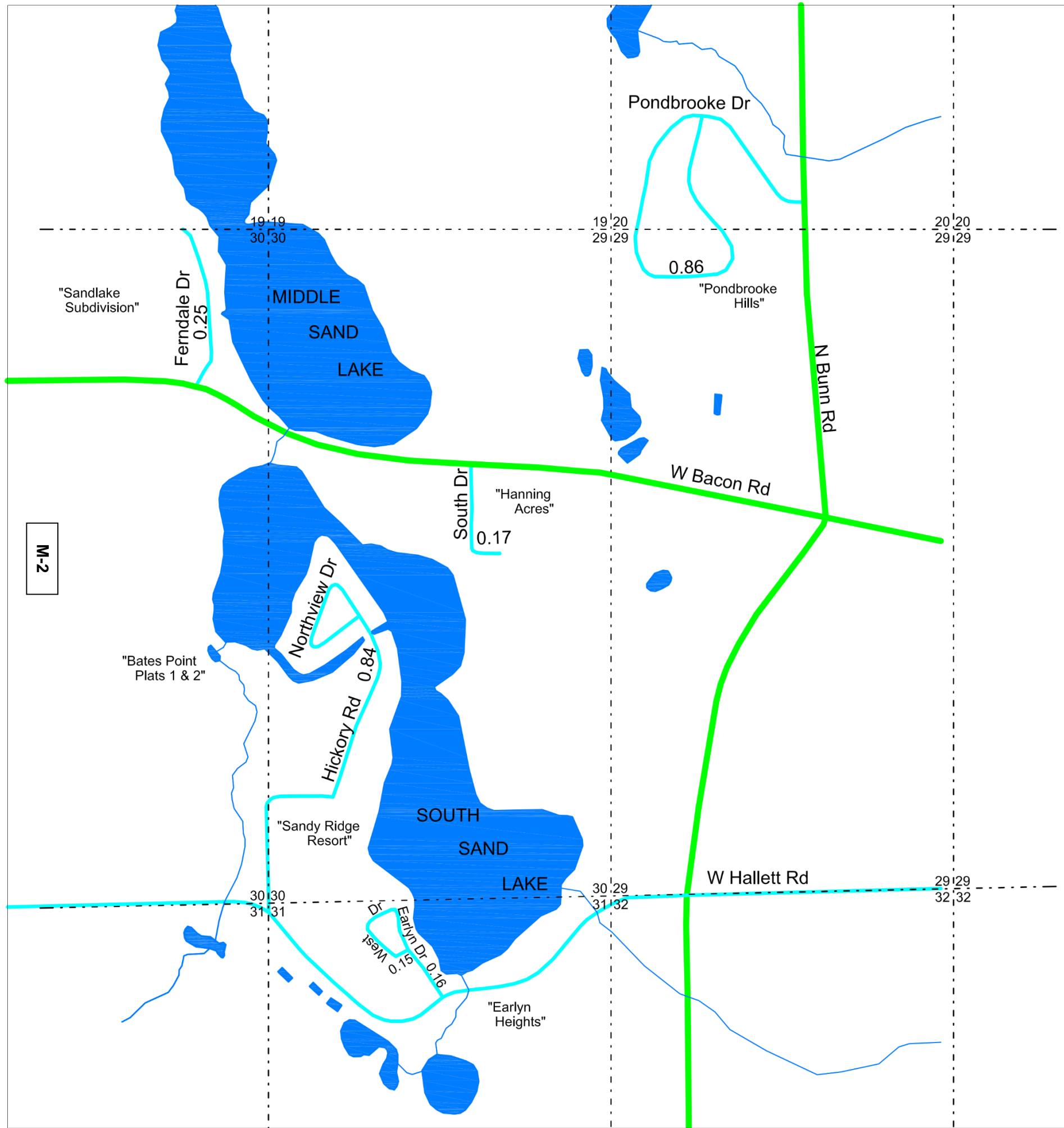

LEGEND

- Twp or County Line
- Corporate Limits
- State Trunkline
- County Primary
- County Local
- Adjacent County

Total Feet 12,831 equals 2.43 miles.

WESTERN HILLSDALE TOWNSHIP

Sections 19, 20, 29, 30, 31 & 32
T6S, R3W
Hillsdale County

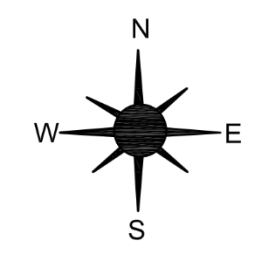

LEGEND

- Twp or County Line
- Corporate Limits
- State Trunkline
- County Primary
- County Local
- Adjacent County

Total Feet 14,150 equals 2.68 miles.

EASTERN HILLSDALE TOWNSHIP

Section 25 T6S, R3W
Hillsdale County

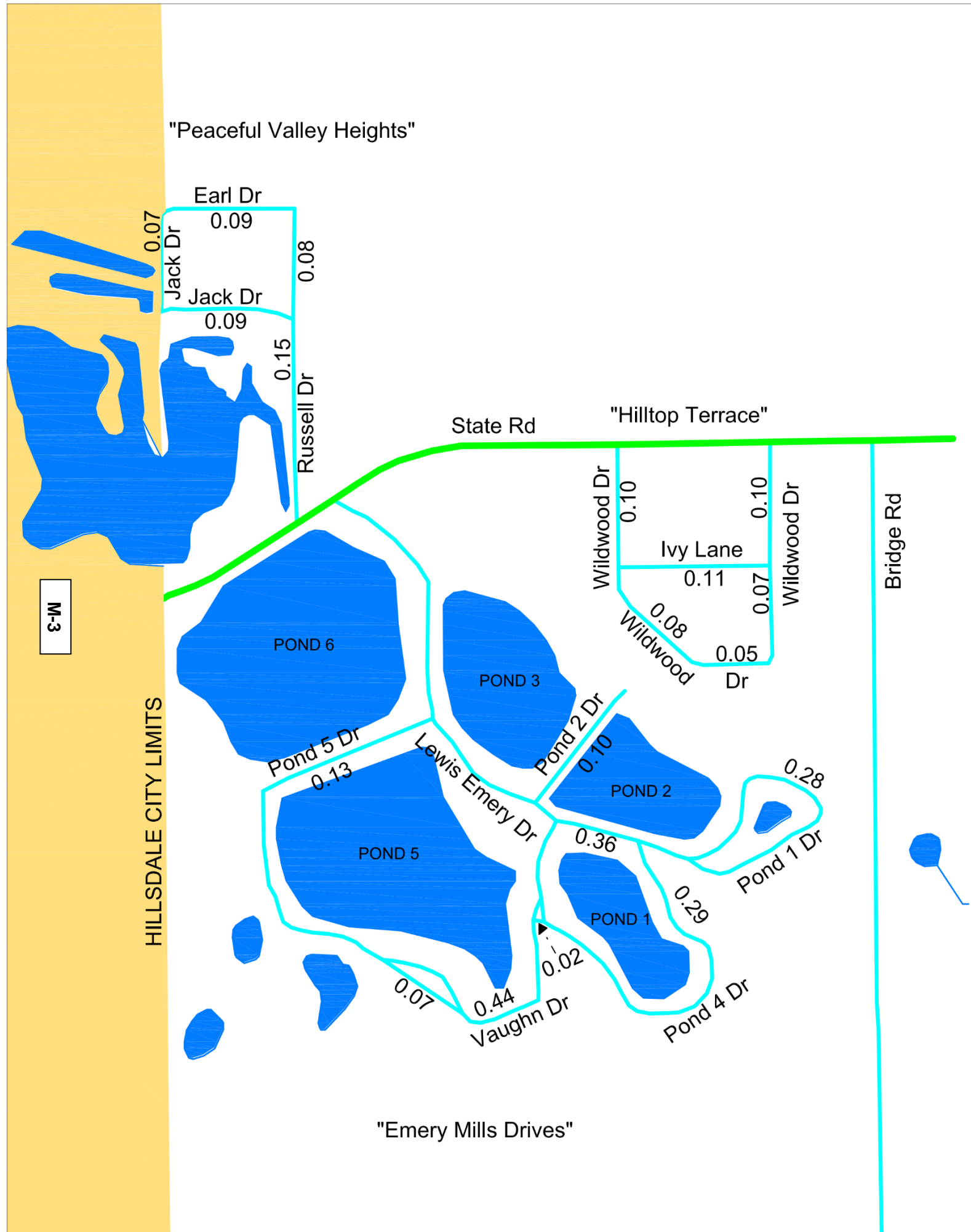
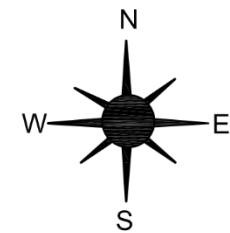

City of Hillsdale

"Baw Beese Heights"
"Baw Beese Heights #2"
"Juanita Heights"

LEGEND

- Twp or County Line -----
- Corporate Limits _____
- State Trunkline —————
- County Primary —————
- County Local —————
- Adjacent County XXXXXXXXXXXXXXXXXX

Total Feet 12,778 equals 2.42 miles.

BAW
BEESE
LAKE

SOUTHERN HILLSDALE TOWNSHIP

Section 35 T6S, R3W
Hillsdale County

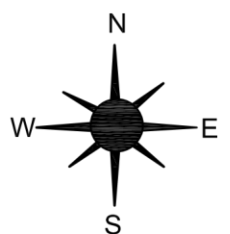

M-4

99

Vera Dr
0.19

Osborn Dr

0.29

Almeda Dr

Helen Dr
0.10

Lanphere St
0.19

0.43

Nakomis St
0.11

Ann St

0.07

Juanita Dr
0.21

Steamburg Rd

Lakeview Dr
0.12

0.71